



fusion 2

...where art, cuisine and music collide!

APRIL 17, 2008



MUSIC

~ GRAND FOYER
~ DUNCAN
~ ROOM 1133
~ REMLABS

Tonight you will have many opportunities to expand your musical horizons through the innovative offerings presented by student performers, composers, and faculty members from The Shepherd School of Music.

GRAND FOYER

7:00 Eric Siu, violin and Neal Kurz, piano

7:15 Aaron Blake, tenor
Bethany Solheim, soprano
Youn Ju Namkoong, piano

DUNCAN RECITAL HALL

7:30 CONCERT (Repeats at 8:45)

The Breathing of Statues by Kenneth Stewart
For Cello and Electronic Sounds
Jacob Fowler, Violoncello

Metamorphoses Nocturnes - Quartet for Strings #1
(first six movements only) by György Ligeti
The Jasper String Quartet
J Freivogel, violin
Sae Niwa, violin
Sam Quintal, viola
Rachel Henderson, cello

GRAND FOYER

8:00 *Four Course Rounds* by Dan Sedgwick
Featuring Alumni of the Houston Boychoir

ROOM 1133

8:15 *Kandinsky, Schoenberg, and Artistic Fusion in 1911*
Presentation by Walter B. Bailey
Associate Professor and Chair of Musicology

GRAND FOYER

8:30 Eric Siu, violin and Neal Kurz, piano

DUNCAN RECITAL HALL

8:45 Repeat performance of the 7:30 p.m. concert

REMLABS - ROOM 1709 - ALL EVENING

Be sure to stop into the Electronic Music Studio to experience the creative work of Ana Paola Santillán Alcocer, Ethan Greene, Daniel Zajicek, Nicolai Jacobsen and Elliot Cole!

YOUR GUIDE TO FUSION 2



CUISINE ~ GRAND FOYER ~ EAST LOBBY

You are invited to sample delicacies from some of Houston's most prominent chefs. Tantalize your tastebuds with samplings from these fine restaurants:

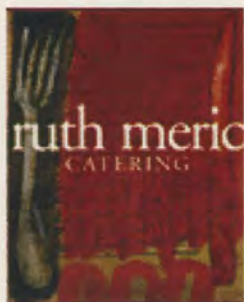

"Who Made the Cake!"

exquisite cakes by Nadine Moon

DAMIAN'S
Cucina Italiana

INDIKA

lemongrass
C A F E

benjy's
MODERN AMERICAN CUISINE



Zula

Then join us in the East Lobby to taste the fine wines of:

| **ROBERT SKALLI** |

HIIS WINE IS HIIS WORD

GRACIOUSLY PROVIDED BY:

S T. SUPÉRY

VINEYARDS & WINERY
NAPA VALLEY

www.stsupery.com



www.vintropolisbar.com



ART ~ STUDE CONCERT HALL

Stude Concert Hall has been transformed into a large gallery space allowing you to immerse yourself in artistic works from the following local galleries:

MCMURTREY GALLERY
featuring the work of Sandi Seltzer Bryant

www.sandiseltzerbryant.com

DARKE | gallery

www.darkegallery.com

Thornwood Gallery

www.thornwoodgallery.com

Archway
Gallery

www.archwaygallery.com

new gallery

thom andriola

www.newgallery.net



MIND Puddles

www.mindpuddles.com

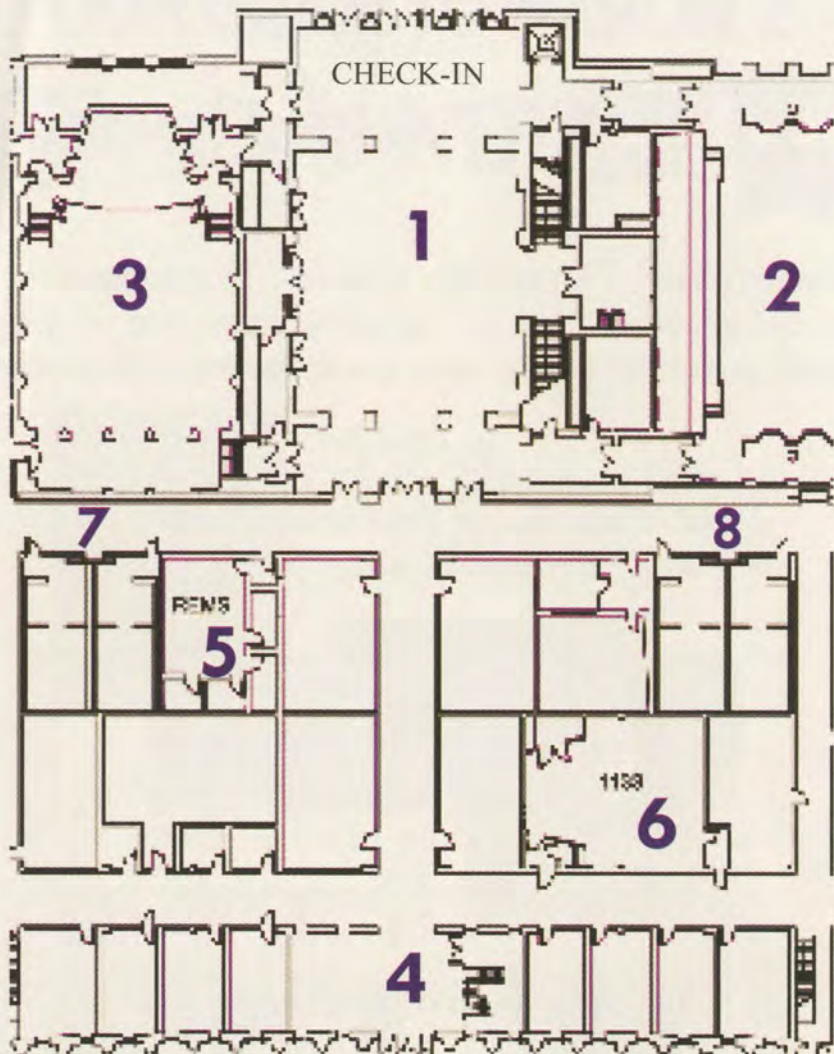

You
Hous
taste

1. GRAND FOYER - FOOD & MUSIC

FOOD SAMPLINGS & MUSICAL INTERLUDES

2. STUDE CONCERT HALL - ART

STROLL ON THE MAIN STAGE TO SEE WHAT OUR
FEATURED ART GALLERIES HAVE TO OFFER!

3. DUNCAN RECITAL HALL - MUSIC

CONCERT AT 7:30 P.M.

REPEAT PERFORMANCE AT 8:45 P.M.

4. EAST LOBBY - WINE TASTING

TASTE SEVERAL OF ROBERT SKALLI'S WINES
BROUGHT TO YOU BY ST. SUPERY and VINTROPOLIS

5. REMLABS (ELECTRONIC MUSIC STUDIO) - MUSIC

STOP BY THROUGHOUT THE EVENING TO SEE OUR
INNOVATIVE COMPOSERS AT WORK!

6. ROOM #1133 - ART & MUSIC TALK

AT 8:15 P.M., JOIN DR. WILLIAM BAILEY FOR A
LOOK AT THE WORKS OF SCHOENBERG &
KANDINSKY

7&8. RESTROOMS



Many thanks to all who made FUSION2 fu

Professor Kurt Stallmann deserves extra special recognition for believing in the concept of FUSION from the start -- and for helping us bring it to life!

Please remember to show your appreciation for the participating chefs, restaurant owners, managers and staff; the artists and gallery owners; the musicians, composers, faculty and students -- by supporting their efforts in the future. Dine at their restaurants, buy art locally, and don't forget to attend our concerts at The Shepherd School of Music!

Special thanks to our staff and volunteers...

Josh Applebee

Bill Bailey

Mandy Billings

Kristi Blair

Noel Burkeen

Autumn England

Doug Falk

Julia Frantz

Becky Henry

Kristi Johnson

Susy Jones

Jenny Lewis

Tom Littman

David Long

Marty Merritt

Kate Munagian

Jennifer Overton

Lizzie Polek

Fran Schmidt

Susie Schoepf

Dean Shank

Kristine Shirar

Nicole Willis Shove

Helen Toombs

Chapman Welch

Leigh Williams

Lizanne Yeates

Shepherd Society Members...

Our thanks would not be complete without offering an extra note of appreciation to all of the members of The Shepherd Society, who provide our talented students with scholarship and audience support throughout each academic year. We are most grateful for your ongoing commitment to and belief in our young musicians!



For more information, visit:
www.theshepherdsociety.org